

#620 EX-POWER® JIS B6339 / MAS 403 BT 一體式設計 Integrated / Monoblock Design

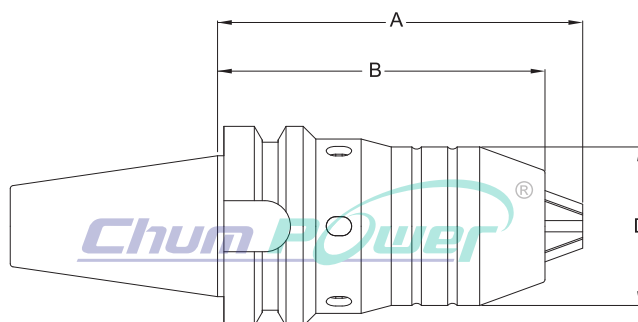

- Designed to maximize drill chuck rigidity and precision on machine centers with automatic tool changer.
- The shank and Universal Drill Chuck are combined as one body, so that the Drill Chuck will not be fallen out when heavy cutting performed.
- The drill will not be dropped out when the main spindle of machine instantly stops.
- High precision can be maintained over a long period of time.
- 設計功能一能增強鑽夾頭的堅固性及精準性，於使用綜合加工中心機的換刀系統。
- 刀柄和鑽夾頭結合為一體。即使是作重切削的加工，鑽夾頭也不會脫落。
- 即使機器主軸立即停止，刀具也不會因此脫落。
- 超過長時間的使用，此夾頭仍保持高精度。



CODE NO 型號	MOUNT TYPE 組接型式	SIZE 尺寸	CAPACITY 夾持量		DIMENSIONS 規格		
			mm	inch	CLOSED A/mm 關	OPEN B/mm 開	SLEEVE D/mm 外徑
62005	BT30	8mm	0-8	0-5/16	92	83	37.5
62010	BT30	13mm	0-13	0-1/2	115	102	50
62015	BT40	8mm	0-8	0-5/16	96	87	37.5
62020	BT40	13mm	0-13	0-1/2	115	102	50
62025	BT40	16mm	3-16	1/8-5/8	121.5	108.5	57