

## ER SPRING COLLET SYSTEM

彈性筒夾 DIN 6499(DIN ISO 15488)

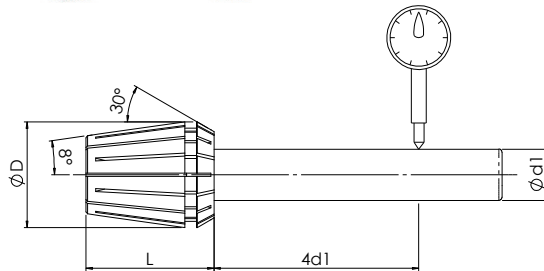

Type	$\phi D$	L
ER08	8.5	13.5
ER11	11.5	18
ER16	17	27
ER20	21	31
ER25	26	35
ER32	33	40
ER40	41	46
ER50	52	60

Runout accuracy 0.02mm . Standard	Type 規格	Runout accuracy 0.01mm A class	Runout accuracy 0.005mm AA class	Type 規格
Code No. 型號		Code No. 型號	Code No. 型號	
BE8000101A	ER8( $\phi$ 1.0-0.5)	BE8100101A	-	-
BE8000102A	ER8( $\phi$ 1.5-1.0)	BE8100102A	-	-
BE8000103A	ER8( $\phi$ 2.0-1.5)	BE8100103A	-	-
BE8000104A	ER8( $\phi$ 2.5-2.0)	BE8100104A	-	-
BE8000105A	ER8( $\phi$ 3.0-2.5)	BE8100105A	-	-
BE8000106A	ER8( $\phi$ 3.5-3.0)	BE8100106A	-	-
BE8000107A	ER8( $\phi$ 4.0-3.5)	BE8100107A	-	-
BE8000108A	ER8( $\phi$ 4.5-4.0)	BE8100108A	-	-
BE8000109A	ER8( $\phi$ 5.0-4.5)	BE8100109A	-	-
BE8000301A	ER11( $\phi$ 1.0-0.5)	BE8100301A	-	-
BE8000302A	ER11( $\phi$ 1.5-1.0)	BE8100302A	-	-
BE8000303A	ER11( $\phi$ 2.0-1.5)	BE8100303A	BE8200301A	ER11( $\phi$ 2.0)
BE8000304A	ER11( $\phi$ 2.5-2.0)	BE8100304A	BE8200302A	ER11( $\phi$ 2.5)
BE8000305A	ER11( $\phi$ 3.0-2.5)	BE8100305A	BE8200303A	ER11( $\phi$ 3.0)
BE8000306A	ER11( $\phi$ 3.5-3.0)	BE8100306A	BE8200304A	ER11( $\phi$ 3.5)
BE8000307A	ER11( $\phi$ 4.0-3.5)	BE8100307A	BE8200305A	ER11( $\phi$ 4.0)
BE8000308A	ER11( $\phi$ 4.5-4.0)	BE8100308A	BE8200306A	ER11( $\phi$ 4.5)
BE8000309A	ER11( $\phi$ 5.0-4.5)	BE8100309A	BE8200307A	ER11( $\phi$ 5.0)
BE8000310A	ER11( $\phi$ 5.5-5.0)	BE8100310A	BE8200308A	ER11( $\phi$ 5.5)
BE8000311A	ER11( $\phi$ 6.0-5.5)	BE8100311A	BE8200309A	ER11( $\phi$ 6.0)
BE8000312A	ER11( $\phi$ 6.5-6.0)	BE8100312A	BE8200310A	ER11( $\phi$ 6.5)
BE8000313A	ER11( $\phi$ 7.0-6.5)	BE8100313A	BE8200311A	ER11( $\phi$ 7.0)
BE8000501A	ER16( $\phi$ 1.0-0.5)	BE8100501A	-	-
BE8000502A	ER16( $\phi$ 1.5-1.0)	BE8100502A	-	-
BE8000503A	ER16( $\phi$ 2.0-1.5)	BE8100503A	BE8200501A	ER16( $\phi$ 2.0)
BE8000504A	ER16( $\phi$ 2.5-2.0)	BE8100504A	-	-
BE8000505A	ER16( $\phi$ 3.0-2.5)	BE8100505A	BE8200502A	ER16( $\phi$ 3.0)
BE8000506A	ER16( $\phi$ 3.5-3.0)	BE8100506A	-	-
BE8000507A	ER16( $\phi$ 4.0-3.5)	BE8100507A	BE8200503A	ER16( $\phi$ 4.0)
BE8000508A	ER16( $\phi$ 4.5-4.0)	BE8100508A	-	-
BE8000509A	ER16( $\phi$ 5.0-4.5)	BE8100509A	BE8200504A	ER16( $\phi$ 5.0)
BE8000510A	ER16( $\phi$ 5.5-5.0)	BE8100510A	-	-
BE8000511A	ER16( $\phi$ 6.0-5.5)	BE8100511A	BE8200505A	ER16( $\phi$ 6.0)
BE8000512A	ER16( $\phi$ 6.5-6.0)	BE8100512A	-	-
BE8000513A	ER16( $\phi$ 7.0-6.5)	BE8100513A	BE8200506A	ER16( $\phi$ 7.0)
BE8000514A	ER16( $\phi$ 7.5-7.0)	BE8100514A	-	-
BE8000515A	ER16( $\phi$ 8.0-7.5)	BE8100515A	BE8200507A	ER16( $\phi$ 8.0)

## ER SPRING COLLET SYSTEM

彈性筒夾 DIN 6499(DIN ISO 15488)

Runout accuracy 0.02mm . Standard	Type 規格	Runout accuracy 0.01mm A class	Runout accuracy 0.005mm AA class	Type 規格
Code No. 型號		Code No. 型號	Code No. 型號	
BE8000516A	ER16(Ø8.5-8.0)	BE8100516A	-	-
BE8000517A	ER16(Ø9.0-8.5)	BE8100517A	BE8200508A	ER16(Ø9.0)
BE8000518A	ER16(Ø9.5-9.0)	BE8100518A	-	-
BE8000519A	ER16(Ø10.0-9.5)	BE8100519A	BE8200509A	ER16(Ø10.0)
BE8000701A	ER20(Ø1.0-0.5)	BE8100701A	-	-
BE8000702A	ER20(Ø1.5-1.0)	BE8100702A	-	-
BE8000703A	ER20(Ø2.0-1.5)	BE8100703A	BE8200701A	ER20(Ø2.0)
BE8000704A	ER20(Ø2.5-2.0)	BE8100704A	-	-
BE8000705A	ER20(Ø3.0-2.5)	BE8100705A	BE8200702A	ER20(Ø3.0)
BE8000706A	ER20(Ø3.5-3.0)	BE8100706A	-	-
BE8000707A	ER20(Ø4.0-3.5)	BE8100707A	BE8200703A	ER20(Ø4.0)
BE8000708A	ER20(Ø4.5-4.0)	BE8100708A	-	-
BE8000709A	ER20(Ø5.0-4.5)	BE8100709A	BE8200704A	ER20(Ø5.0)
BE8000710A	ER20(Ø5.5-5.0)	BE8100710A	-	-
BE8000711A	ER20(Ø6.0-5.5)	BE8100711A	BE8200705A	ER20(Ø6.0)
BE8000712A	ER20(Ø6.5-6.0)	BE8100712A	-	-
BE8000713A	ER20(Ø7.0-6.5)	BE8100713A	BE8200706A	ER20(Ø7.0)
BE8000714A	ER20(Ø7.5-7.0)	BE8100714A	-	-
BE8000715A	ER20(Ø8.0-7.5)	BE8100715A	BE8200707A	ER20(Ø8.0)
BE8000716A	ER20(Ø8.5-8.0)	BE8100716A	-	-
BE8000717A	ER20(Ø9.0-8.5)	BE8100717A	BE8200708A	ER20(Ø9.0)
BE8000718A	ER20(Ø9.5-9.0)	BE8100718A	-	-
BE8000719A	ER20(Ø10.0-9.5)	BE8100719A	BE8200709A	ER20(Ø10.0)
BE8000720A	ER20(Ø10.5-10.0)	BE8100720A	-	-
BE8000721A	ER20(Ø11.0-10.5)	BE8100721A	BE8200710A	ER20(Ø11.0)
BE8000722A	ER20(Ø11.5-11.0)	BE8100722A	-	-
BE8000723A	ER20(Ø12.0-11.5)	BE8100723A	BE8200711A	ER20(Ø12.0)
BE8000724A	ER20(Ø12.5-12.0)	BE8100724A	-	-
BE8000725A	ER20(Ø13.0-12.5)	BE8100725A	BE8200712A	ER20(Ø13.0)
BE8000901A	ER25(Ø1.0-0.5)	-	-	-
BE8000902A	ER25(Ø1.5-1.0)	-	-	-
BE8000903A	ER25(Ø2.0-1.0)	BE8100903A	BE8200901A	ER25(Ø2.0)
BE8000904A	ER25(Ø3.0-2.0)	BE8100904A	BE8200902A	ER25(Ø3.0)
BE8000905A	ER25(Ø4.0-3.0)	BE8100905A	BE8200903A	ER25(Ø4.0)
BE8000906A	ER25(Ø5.0-4.0)	BE8100906A	BE8200904A	ER25(Ø5.0)
BE8000907A	ER25(Ø6.0-5.0)	BE8100907A	BE8200905A	ER25(Ø6.0)
BE8000908A	ER25(Ø7.0-6.0)	BE8100908A	BE8200906A	ER25(Ø7.0)
BE8000909A	ER25(Ø8.0-7.0)	BE8100909A	BE8200907A	ER25(Ø8.0)
BE8000910A	ER25(Ø9.0-8.0)	BE8100910A	BE8200908A	ER25(Ø9.0)
BE8000911A	ER25(Ø10.0-9.0)	BE8100911A	BE8200909A	ER25(Ø10.0)
BE8000912A	ER25(Ø11.0-10.0)	BE8100912A	BE8200910A	ER25(Ø11.0)
BE8000913A	ER25(Ø12.0-11.0)	BE8100913A	BE8200911A	ER25(Ø12.0)
BE8000914A	ER25(Ø13.0-12.0)	BE8100914A	BE8200912A	ER25(Ø13.0)
BE8000915A	ER25(Ø14.0-13.0)	BE8100915A	BE8200913A	ER25(Ø14.0)
BE8000916A	ER25(Ø15.0-14.0)	BE8100916A	BE8200914A	ER25(Ø15.0)
BE8000917A	ER25(Ø16.0-15.0)	BE8100917A	BE8200915A	ER25(Ø16.0)
BE8001101A	ER32(Ø2.0-1.0)	-	-	-
BE8001102A	ER32(Ø3.0-2.0)	BE8101102A	BE8201101A	ER32(Ø3.0)
BE8001103A	ER32(Ø4.0-3.0)	BE8101103A	BE8201102A	ER32(Ø4.0)
BE8001104A	ER32(Ø5.0-4.0)	BE8101104A	BE8201103A	ER32(Ø5.0)
BE8001105A	ER32(Ø6.0-5.0)	BE8101105A	BE8201104A	ER32(Ø6.0)
BE8001106A	ER32(Ø7.0-6.0)	BE8101106A	BE8201105A	ER32(Ø7.0)
BE8001107A	ER32(Ø8.0-7.0)	BE8101107A	BE8201106A	ER32(Ø8.0)
BE8001108A	ER32(Ø9.0-8.0)	BE8101108A	BE8201107A	ER32(Ø9.0)
BE8001109A	ER32(Ø10.0-9.0)	BE8101109A	BE8201108A	ER32(Ø10.0)
BE8001110A	ER32(Ø11.0-10.0)	BE8101110A	BE8201109A	ER32(Ø11.0)

## ER SPRING COLLET SYSTEM

彈性筒夾 DIN 6499(DIN ISO 15488)

Runout accuracy 0.02mm . Standard	Type 規格	Runout accuracy 0.01mm A class	Runout accuracy 0.005mm AA class	Type 規格
Code No. 型號		Code No. 型號	Code No. 型號	
BE8001111A	ER32(Ø12.0-11.0)	BE8101111A	BE8201110A	ER32(Ø12.0)
BE8001112A	ER32(Ø13.0-12.0)	BE8101112A	BE8201111A	ER32(Ø13.0)
BE8001113A	ER32(Ø14.0-13.0)	BE8101113A	BE8201112A	ER32(Ø14.0)
BE8001114A	ER32(Ø15.0-14.0)	BE8101114A	BE8201113A	ER32(Ø15.0)
BE8001115A	ER32(Ø16.0-15.0)	BE8101115A	BE8201114A	ER32(Ø16.0)
BE8001116A	ER32(Ø17.0-16.0)	BE8101116A	BE8201115A	ER32(Ø17.0)
BE8001117A	ER32(Ø18.0-17.0)	BE8101117A	BE8201116A	ER32(Ø18.0)
BE8001118A	ER32(Ø19.0-18.0)	BE8101118A	BE8201117A	ER32(Ø19.0)
BE8001119A	ER32(Ø20.0-19.0)	BE8101119A	BE8201118A	ER32(Ø20.0)
BE8001301A	ER40(Ø3.0-2.0)	BE8101301A	-	-
BE8001302A	ER40(Ø4.0-3.0)	BE8101302A	BE8201301A	ER40(Ø4.0)
BE8001303A	ER40(Ø5.0-4.0)	BE8101303A	BE8201302A	ER40(Ø5.0)
BE8001304A	ER40(Ø6.0-5.0)	BE8101304A	BE8201303A	ER40(Ø6.0)
BE8001305A	ER40(Ø7.0-6.0)	BE8101305A	BE8201304A	ER40(Ø7.0)
BE8001306A	ER40(Ø8.0-7.0)	BE8101306A	BE8201305A	ER40(Ø8.0)
BE8001307A	ER40(Ø9.0-8.0)	BE8101307A	BE8201306A	ER40(Ø9.0)
BE8001308A	ER40(Ø10.0-9.0)	BE8101308A	BE8201307A	ER40(Ø10.0)
BE8001309A	ER40(Ø11.0-10.0)	BE8101309A	BE8201308A	ER40(Ø11.0)
BE8001310A	ER40(Ø12.0-11.0)	BE8101310A	BE8201309A	ER40(Ø12.0)
BE8001311A	ER40(Ø13.0-12.0)	BE8101311A	BE8201310A	ER40(Ø13.0)
BE8001312A	ER40(Ø14.0-13.0)	BE8101312A	BE8201311A	ER40(Ø14.0)
BE8001313A	ER40(Ø15.0-14.0)	BE8101313A	BE8201312A	ER40(Ø15.0)
BE8001314A	ER40(Ø16.0-15.0)	BE8101314A	BE8201313A	ER40(Ø16.0)
BE8001315A	ER40(Ø17.0-16.0)	BE8101315A	BE8201314A	ER40(Ø17.0)
BE8001316A	ER40(Ø18.0-17.0)	BE8101316A	BE8201315A	ER40(Ø18.0)
BE8001317A	ER40(Ø19.0-18.0)	BE8101317A	BE8201316A	ER40(Ø19.0)
BE8001318A	ER40(Ø20.0-19.0)	BE8101318A	BE8201317A	ER40(Ø20.0)
BE8001319A	ER40(Ø21.0-20.0)	BE8101319A	BE8201318A	ER40(Ø21.0)
BE8001320A	ER40(Ø22.0-21.0)	BE8101320A	BE8201319A	ER40(Ø22.0)
BE8001321A	ER40(Ø23.0-22.0)	BE8101321A	BE8201320A	ER40(Ø23.0)
BE8001322A	ER40(Ø24.0-23.0)			
BE8001323A	ER40(Ø25.0-24.0)			
BE8001324A	ER40(Ø26.0-25.0)			
BE8001501A	ER50(Ø6.0-5.0)			
BE8001502A	ER50(Ø7.0-6.0)			
BE8001503A	ER50(Ø8.0-7.0)			
BE8001504A	ER50(Ø9.0-8.0)			
BE8001505A	ER50(Ø10.0-9.0)			
BE8001506A	ER50(Ø11.0-10.0)			
BE8001507A	ER50(Ø12.0-10.0)			
BE8001508A	ER50(Ø14.0-12.0)			
BE8001509A	ER50(Ø16.0-14.0)			
BE8001510A	ER50(Ø18.0-16.0)			
BE8001511A	ER50(Ø20.0-18.0)			
BE8001512A	ER50(Ø22.0-20.0)			
BE8001513A	ER50(Ø24.0-22.0)			
BE8001514A	ER50(Ø26.0-24.0)			
BE8001515A	ER50(Ø28.0-26.0)			
BE8001516A	ER50(Ø30.0-28.0)			
BE8001517A	ER50(Ø32.0-30.0)			
BE8001518A	ER50(Ø34.0-32.0)			