

Shaft Coupling 連軸器

■ Design Features

- According to DIN 69002 .which is suitable for multiple spindle drives.
- Developed for stub spindles
 - Integrated clamping system
 - Designed for main spindle drives with high speeds
 - Suitable for peripheral speeds of 50 m/s and more
 - Backlash-free and high precisely shaft coupling
 - Easy assembly by clamping and simply screws inside

■ 特點

- 依據 DIN69002 標準製作，適用於複合加工機
- 具完備的短軸規格
- 結合完整的夾具系統
- 針對高轉速主軸設計
- 可適用於圓周回轉速 50m/s 以上
- 具高精度、動平衡結構
- 易拆裝



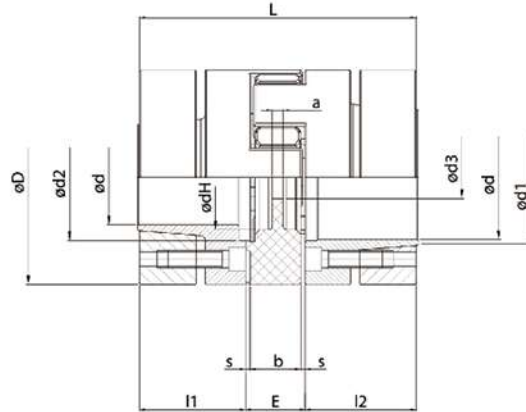

| Code No. 型號 | Size 尺寸 | Dimensions(mm) 規格 | | | | | | | | | | | |
|----------------|------------|-------------------|------|------|-----|-------|----|----|-----|-----|----|----|------|
| | | d | D | dH | L | I1:I2 | E | b | s | a | d1 | d2 | d3 |
| BTSAA000101A | 14P | 14" | 32 | 10.5 | 50 | 18.5 | 13 | 10 | 1.5 | 2 | 17 | 17 | 8.5 |
| BTSAA000102A | 19P37.5 | 16" | 37.5 | 18 | 66 | 25 | 16 | 12 | 2 | 3 | 20 | 19 | 9.5 |
| BTSAA000103A | 19P | 19" | 40 | 18 | 66 | 25 | 16 | 12 | 2 | 3 | 23 | 22 | 9.5 |
| BTSAA000104A | 24P50 | 24" | 50 | 27 | 78 | 30 | 18 | 14 | 2 | 3 | 28 | 29 | 12.5 |
| BTSAA000105A | 24P | 25" | 55 | 27 | 78 | 30 | 18 | 14 | 2 | 3 | 30 | 30 | 12.5 |
| BTSAA000106A | 28P | 35" | 65 | 30 | 90 | 35 | 20 | 15 | 2.5 | 4 | 40 | 40 | 14.5 |
| BTSAA000107A | 38P | 40" | 80 | 38 | 114 | 45 | 24 | 18 | 3 | 4 | 46 | 46 | 16.5 |
| BTSAA000108A | 42P | 42" | 95 | 46 | 126 | 50 | 26 | 20 | 3 | 4 | 52 | 55 | 18.5 |
| BTSAA000109A | 48P | 45" | 105 | 51 | 140 | 56 | 28 | 21 | 3.5 | 4 | 52 | 60 | 20.5 |
| BTSAA000110A | 55P | 50" | 120 | 60 | 160 | 65 | 30 | 22 | 4 | 4.5 | 55 | 72 | 22.5 |

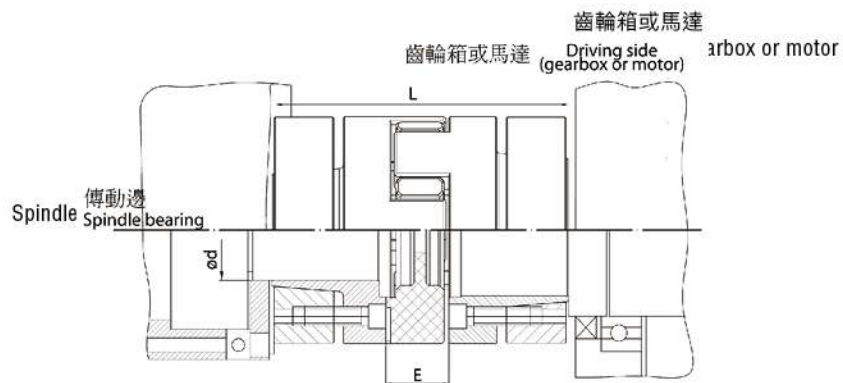

| Spindle drive Size | Size | Dimensions(mm) 規格 | | | | |
|--------------------|----------|-------------------|------|-------|----|----|
| | | d | D | I1:I2 | L | E |
| 25x20 | 14 P | 14 | 32 | 18.5 | 50 | 13 |
| 32kx25 | 19 P37.5 | 16 | 37.5 | 25 | 66 | 16 |
| 32gx30 | 19 P | 19 | 40 | 25 | 66 | 16 |
| 40x35 | 24 P50 | 24 | 50 | 30 | 78 | 18 |
| 50x45 | 24 P | 25 | 55 | 30 | 78 | 18 |
| 63x55 | 28 P | 35 | 65 | 35 | 90 | 20 |